



LIGHTING CONTROL FOR THE  
LIFE OF THE BUILDING.

# RETROFITTING FOR THE FUTURE

NexLight Lighting Control :: Application Guide

# RETROFITTING FOR THE FUTURE

## Retrofit Today... Save Tomorrow

NexLight delivers the simple, reliable and flexible lighting control retrofit solutions.

- **Significantly increase energy efficiency**
- **Occupants have greater control of their space**
- **Facility managers easily monitor and make adjustments anytime**
- **Valuable to those who own operate and use the building**

With thousands of installations around the country over the last 20 years, NexLight continues to offer the industry best system solutions.

## Simple to Install and Operate

NexLight systems communicate with a simple 2-Wire data connection. The benefit for most retrofits projects are:

- **Minimal rewiring (if any)**
- **Minimal interruption of day-to-day business**
- **No damage to the facility (use existing infrastructure where possible)**
- **No limit to building size or age**

## Reliable for a Lifetime

High-quality, long-life components and industrial construction makes the NexLight system extremely reliable.

- **Industry best relays**
- **Industrial grade construction**
- **5-year warranty guarantee**

## Flexible for Any Scenario

Needs and facilities change, the NexLight system is able to grow and change with the needs of any commercial facility.

- **Scalable system architecture**
- **Upgrading the system is simple**
- **Centralized or decentralized**



"A superior lighting control system enhances the performance, flexibility and simplicity of control in a facility. At the same time, lighting control helps to save energy and reduce costs. No one delivers the results like NexLight!"

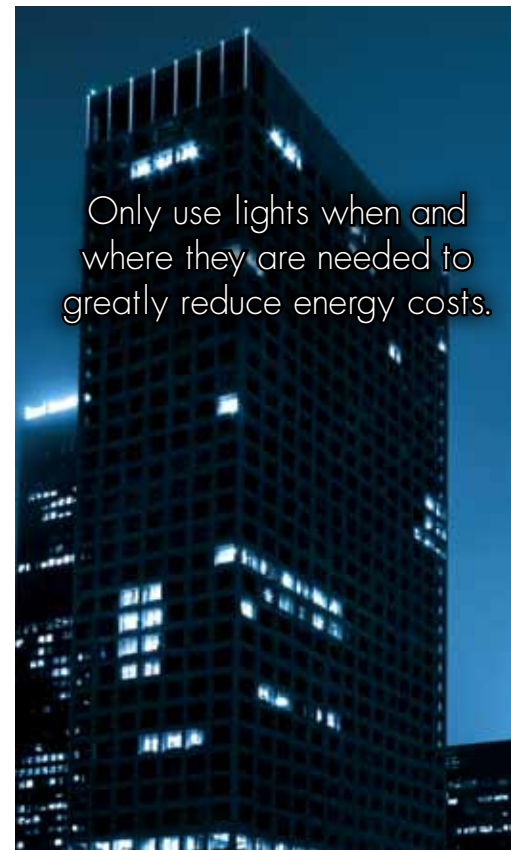

Only use lights when and where they are needed to greatly reduce energy costs.

## USE LIGHT MORE INTELLIGENTLY AND SAVE

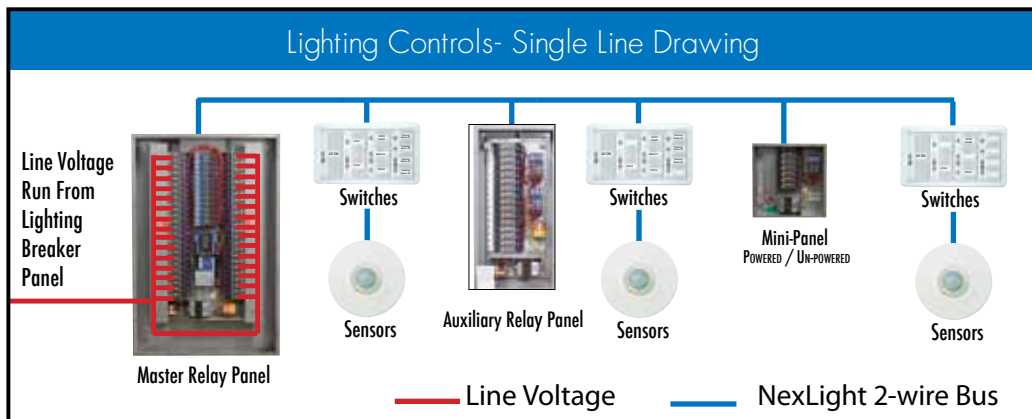

# DISTRIBUTED SYSTEMS FOR MAXIMUM FLEXIBILITY

## ADD SWITCHES, DIMMERS, & SENSORS WHERE NEEDED

Relay Panel Located Near  
Circuit Breaker

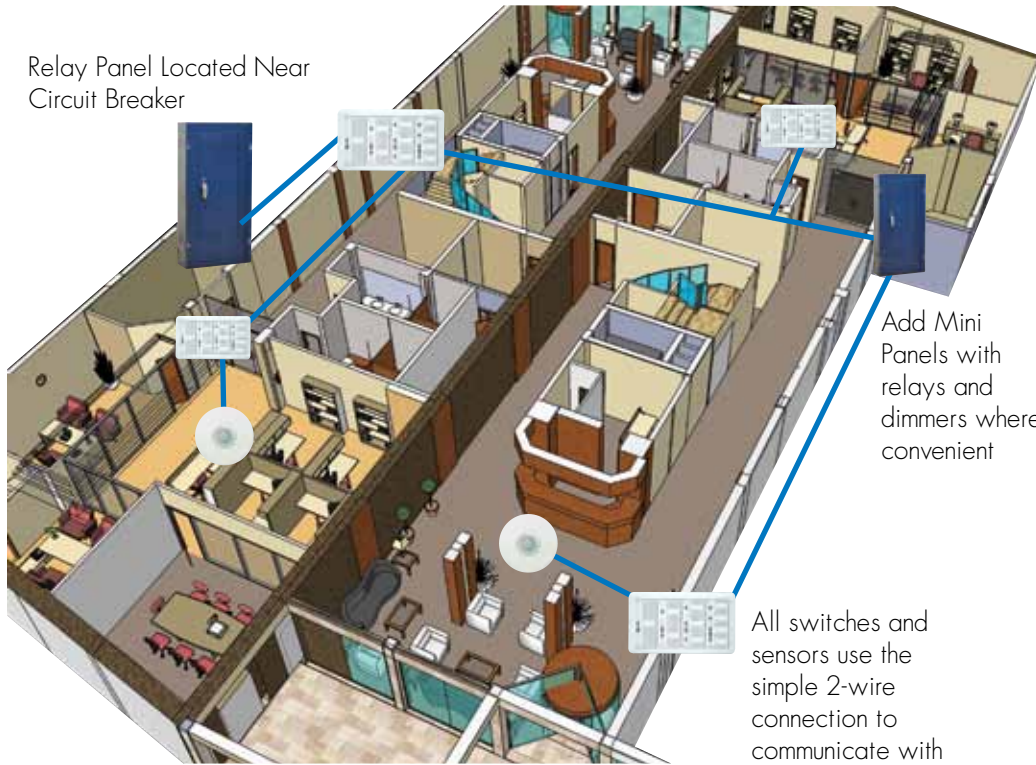

Add Mini  
Panels with  
relays and  
dimmers where  
convenient

All switches and  
sensors use the  
simple 2-wire  
connection to  
communicate with  
the system

Connect the whole system  
with Just 2 Wires!

— NexLight 2-wire Bus

**Topology Free**- Star-Tap, Daisy-Chain and T-Tap are acceptable for wiring.

**Polarity Free**- Makes wiring simple

NexLight's distributed control leaves the options up to you. No need to struggle with trying to get conduits for switch legs through brick walls to get to the relay panel.

To make it easier, you just move the relays and dimmers into junction boxes located near the load, connecting a low voltage pair of wires to the box for control.

**Flexibility of the NexLight 2-wire System provides endless options.**

## THE ULTIMATE CONTROL SOLUTION



### Case Study: Cathedral of St. Paul

The 100 Year-old Cathedral of St. Paul demonstrates how the NexLight 2-wire system is the best choice when retrofitting a facility.

The retrofit connected all the interior and exterior lighting to a centralized location for monitoring and adjustment.

Most importantly the controls system was installed without any rewiring, drilling or damage to the historic facility.

Ten years later, the system is still operating like the day it was installed. Providing dramatic energy savings and automated lighting scenes day and night.



# CUSTOMER SERVICE CUSTOMER SUPPORT

**Local Service:** It all starts with the NexLight sales representative in your area. Our local lighting control specialists are here to support you every step of the way.

**360° Support:** Every NexLight system includes the lifetime 360° support program, ensuring a fully operational system for the life of the building. The quality of a NexLight system is so unmatched in the industry, it provides the confidence to back it with lifetime service and support. Its no wonder why NexLight is number one for customer service.

#1 for  
CUSTOMER SERVICE



# DESIGNING A SYSTEM EASY TO SPECIFY

**We Make It Easy:** NexLight makes it easy to design and order a system. Whether the project is 5,000 square feet or 5 million, NexLight is there every step of the way to ensure that all the needs of the project are met.

**Get What You Want:** We help you design your system and select the right products so you can create a lighting control system that does exactly what you want while saving energy, meeting codes and standards, and earning rebates.

**Factory Support:** NexLight has a highly skilled staff ready to assist you with designing and specifying a system. Contact us today to get started, our turn-around time for quotes is the one of the fastest in the industry.



No one makes it easier...  
"Just Send Us the Plans"

**CONTACT YOUR LOCAL NEXLIGHT LIGHTING CONTROL SPECIALIST  
FOR SPECIFICATION AND DESIGN ASSISTANCE, OR CALL 218-828-3700**

## NEXLIGHT LIGHTING CONTROLS

7877 College Road, Baxter, MN 56425

Tel:218-828-3700

Visit us online at [www.nexlight.com](http://www.nexlight.com)

